

## CONTENTS

- 02 Important safeguards
- 03 Cautions during Operation
- 04 Precautions for safe use
- 06 Parts and Accessories
- 08 How to disassemble the chamber
- 09 How to trim the ingredients / Use by strainer types
- 10 How to assemble : For juicing
- 12 How to assemble : For making Ice cream
- 14 How to assemble the chamber set and body
- 15 How to use : For juicing / Ice cream
- 16 How to use control lever by mode
- 17 How to use control lever by ingredients (Juicing)
- 18 Assembling and cleaning for squeezer
- 19 How to use squeezer and caution
- 20 How to Clean / How to Clean : Silicones
- 22 Before Requesting for Repair
- 24 When the Squeezing Screw stops during operation
- 25 Product Specifications / Warranty

## H-AE Series ( For Household Use Only / Warranty Included )

- 1. Read 'Precautions for safe use' (Page 4) and use the appliance properly.
- 2. After finish reading the manual, keep it in a convenient location for future reference.
- 3. Do not use it abroad which has different power supply and voltage.
- 4. Any quality improvements are subject to change without notice.

## IMPORTANT SAFEGUARDS

The following basic safety precautions apply when using electrical appliances :

1. When using electrical appliances, basic safety precautions should always be followed. Read all instructions.
2. To protect against risk of electrical shock, do not put the main body (motor) in water or any other liquid.
3. Close supervision is necessary when any appliance is used near children.
4. Unplug from outlet when not in use, before assembling or taking off parts and before cleaning.
5. Avoid contact with moving parts.
6. Do not operate any appliance with a damaged cord or plug, or after the appliance malfunctions, or is dropped or damaged in any manner. Return appliance to the nearest authorized service facility for examination, repair or electrical or mechanical adjustment.
7. The use of attachments not recommended or sold by the manufacturer may cause fire, electric shock or injury.
8. Do not let cord hang over edge of table or counter.
9. Always make sure hopper is securely fastened in place before motor is turned on. Do not unfasten hopper while juicer is in operation.
10. Be sure to turn switch to off position after each use of your juicer. Make sure the motor stops completely before disassembling.
11. Do not put your fingers or other objects into the juicer while it is in operation. If food becomes lodged in opening, use food pusher or another piece of fruit or vegetable to push it down. When this method is not possible, turn the motor off and disassemble juicer to remove the remaining food.
12. Do not use outdoors.
13. Do not place on or near a hot gas or electric burner or in a heated oven.
14. Do not use appliance for other than intended use

## SAVE THESE INSTRUCTIONS

### Cautions during Operation

**\* Ingredients which needs caution.**

**It may cause damage or failure.**

- Fruits with hard seeds such as persimmon, Japanese apricot, lemon, plum, peach etc. that are hard to chew with our teeth should be taken out before extraction.
- For stalk vegetables with strong fiber such as water parsleys, celery etc. should be cut into small size about 3~4cm before putting into the hopper chute.
- Do not put in sesame, coffee beans, bark of the tree, Chinese pepper, etc. which cannot be extracted.
- Do not put in fruits preserved in alcohol, sugar, honey, etc. (grapes, apricot, berries, etc.) and enzymes (glasswort, house leek, etc.).
- Do not insert ingredients that cannot be juiced due to their characteristics, such as figs, aloe and cactus.  
(Please contact the Customer Service Center for more information on which ingredients can be juiced.)
- Extracting the juice from a large amount of root vegetables, including ginger, may cause damage or failure. Please repeat the process of "juicing 1kg, disassembling and cleaning".

**\* We recommend you to drink green vegetable juice and fruit juice immediately after extraction rather than keeping them for long time.**

**\* Do not use for grinding grains.**

- It may cause damage or failure.

**\* Do not re-squeeze residues expelled through the pulp outlet.**

- Soft fruits can be re-squeezed.

**\* Do not operate the appliance before putting in the ingredients.**

**\* Do not use the appliance for more than 30 minutes continuously.**

- It may cause a failure due to overheating of the motor.
- When using continuously, stop it and give it 5 minutes of interval and then you may use it again.

**\* Never insert chopsticks or spoon into Pulp outlet during the operation.**

- Inserting such as chopsticks etc. into Pulp outlet during operation may cause them to stuck into the spinning brush and cause damage to the parts.

**\* Do not press the ingredients with anything except the pusher.**

- It may stick to the screw and cause injury and failure.

**\* Do not operate the switch with wet hands.**

- It may cause electric shock or fire. Do not put foreign objects near the switch.

**\* When you extract over 400ml at once, please open the control lever every 400ml to emit the pulp.**

- The hopper can't be opened or it may cause damage when the pressure in the chamber increases.

**\* Please use only ice cream strainer when you put frozen fruits.**

**\* Do not put the ice cube, other ingredients and for grinding.**

- It may cause damage or failure.

#### Note

Withered ingredients because of refrigerated for long term may make small amount of juice or impossible to make juice. If the unit is not cleaned immediately after use, a residue may dry and stick to the unit. This will make assembling and cleaning difficult as well as lead to performance degradation.



**Warning** When violating the labeling requirement, it may cause serious injury or death.

## Precautions for safe use

- **DO NOT PLUG IN NOR UNPLUG WITH WET HANDS.** It may cause electric shock or injury.
- **DO NOT USE OTHER THAN 120V AC.** It may cause electric shock, fire or abnormal performance. If the voltage is different, it may shorten the life of the motor or cause a failure.
- **PLUG THE POWER CORD CORRECTLY AND PUSH IT TIGHT IN A WALL SOCKET.** It may cause an electric shock or a fire.
- **IF THE SUPPLY CORD IS DAMAGED, IT MUST BE REPLACED BY THE MANUFACTURER'S ITS SERVICE OR SIMILARLY QUALIFIED PERSONS IN ORDER TO AVOID A HAZARD.** If the power cord is damaged, it may cause electric shock or fire.
- **NEVER ALTER THE APPLIANCE. ALSO, DO NOT DISASSEMBLE NOR REPAIR BY YOURSELF. DO NOT INSERT FINGERS, FOREIGN SUBSTANCES OR OBJECTS SUCH AS PINS INTO GAPS OR HOLES IN THE BASE.** It may cause a fire, electric shock or failure. For any technical support, contact the authorized local Customer Care Center.
- **WHEN THE POWER CORD, WIRE IS BROKEN OR DAMAGED OR THE PLUG-IN PART BECOMES LOOSE, DO NOT OPERATE IT.** It may cause electric shock, fire or injury.
- **DO NOT MOISTEN THE BASE OR SPLASH WATER ON THE BASE.** Be careful not to let any liquids or other substances get into the switch on the appliance.
- **DO NOT OPERATE THE SWITCH WITH WET HANDS.** It may cause an electric shock or fire.
- **FOR SAFETY, MUST DO GROUNDING CONNECTION. ALSO, DO NOT DO GROUNDING ON GAS PIPE, PLASTIC WATER PIPE, TELEPHONE WIRE, ETC.** It could cause electric shock, fire, malfunction or explosion. Be sure to use the electrical outlet with ground connection.
- **NEVER DISASSEMBLE THE CHAMBER SET DURING OPERATION NOR INSERT FINGERS, FOREIGN OBJECTS SUCH AS FORKS, SPOONS, ETC. INTO HOPPER CHUTE OR JUICE OUTLET.** It may cause injury, accident or failure.
- **APPLIANCES CAN BE USED BY PERSONS WITH REDUCED PHYSICAL, SENSORY OR MENTAL CAPABILITIES OR LACK OF EXPERIENCE AND KNOWLEDGE IF THEY HAVE BEEN GIVEN SUPERVISION OR INSTRUCTION CONCERNING USE OF THE APPLIANCE IN A SAFE WAY AND IF THEY UNDERSTAND THE HAZARDS INVOLVED. CHILDREN SHALL NOT PLAY WITH THE APPLIANCE. CLEANING AND USER MAINTENANCE SHALL NOT BE MADE BY CHILDREN. THIS APPLIANCE SHALL NOT BE USED BY CHILDREN. KEEP THE APPLIANCE OUT OF REACH OF CHILDREN.**
- **DO NOT OPERATE WITHOUT LOCKING THE HOPPER PROPERLY.** It may cause an injury or a failure.
- **WHEN DETECTING A GAS LEAK, DO NOT INSERT THE POWER CORD INTO ITS SLOT. OPEN THE WINDOW TO VENTILATE FULLY AND IMMEDIATELY.** It may cause injury or failure.



**Caution** When violating the labeling requirement, it may cause serious injury or damage to the appliance.

- **NEVER PUT A FINGER, FORK OR SPOON, ETC. INTO THE JUICE OUTLET.** It may cause injury or failure.
- **IF SQUEEZING SCREW ROTATION IS STOPPED FROM NORMAL OPERATION, PRESS [REV] BUTTON AND HOLD FOR 3~5 SECONDS AND THEN AFTER REVERSE OPERATION IS COMPLETELY STOPPED, PRESS [ON] BUTTON AGAIN.** If such a stop event continues during the operation, the parts may be damaged and performance may be deteriorated due to overheating in a motor. When the problem continues, immediately stop the appliance and contact the local Customer Care Center.
- **DURING THE OPERATION, DO NOT ATTEMPT TO MOVE THE BASE, DISASSEMBLE THE CHAMBER SET OR PARTS, AND TRY TO LOCK THEM.** It may cause an injury or a failure. Any act of event needed, switch off first and unplug the power cord.
- **WHEN USING THE APPLIANCE, BE CAREFUL FOR A NECKTIE, LONG NECKLACE, SCARF, ETC. NOT TO BE ENTANGLED INTO THE HOPPER CHUTE.** It may cause injury, failure or breakage.
- **PLACE THE APPLIANCE ON A FLAT AND STABLE SURFACE.** It may cause injury or failure.
- **DO NOT OPERATE THE APPLIANCE FOR MORE THAN 30 MINUTES AT A TIME.** It may cause a motor failure due to overheating. Cool it down sufficiently about 5 minutes and operate it again.
- **WHEN PLACING INGREDIENTS INTO THE HOPPER CHUTE, ONLY USE THE PUSHER PROVIDED.** It may cause injury or failure.
- **DO NOT ALLOW A SEVERE SHOCK TO THE APPLIANCE NOR DROP IT.** It may cause electric shock, fire or damage.
- **IF THE APPLIANCE GIVES OFF AN UNPLEASANT SMELL OR EXCESSIVE HEATING, SMOKE, STOP USING IMMEDIATELY AND CONTACT THE LOCAL CUSTOMER CARE CENTER.** When using a new appliance, it gives off a smell and the smell disappears naturally over time.
- **ALWAYS UNPLUG THE APPLIANCE AFTER USE. ALWAYS DISCONNECT THE APPLIANCE FROM THE SUPPLY IF IT IS LEFT UNATTENDED AND BEFORE ASSEMBLING, DISASSEMBLING OR CLEANING. WHEN UNPLUGGING THE POWER CORD, MAKE SURE TO HOLD THE POWER CORD.** Pulling on the wire to unplug may cause electric shock or fire.
- **DO NOT WASH AT HIGH TEMPERATURES OF 80°C(176°F) OR HIGHER. DO NOT PUT THE APPLIANCE IN A DISHWASHER, A DRYER OR A MICROWAVE ETC.** It may cause a failure or parts deformation.
- **THE APPLIANCE WEIGHS ABOUT 6.6KG (14.5LB). WHEN MOVING THE APPLIANCE, ENSURE TO MOVE IT HOLDING GRIPS TIGHTLY AT THE BASE BOTTOM WITH BOTH HANDS.** If attempting to hold chamber or the edge of the base, the base falls causing an injury or failure.
- **DO NOT USE HOUSEHOLD PRODUCTS FOR COMMERCIAL PURPOSES.** Forcing a large amount of ingredients to be extracted may damage the parts. Please contact the Customer Service Center for information on how to use the product for commercial purposes.

06

## Parts and Accessories

## 01 Hopper



## 02 Spinning Brush

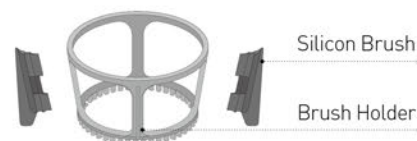

## 03 Squeezing Screw



## 04 Chamber

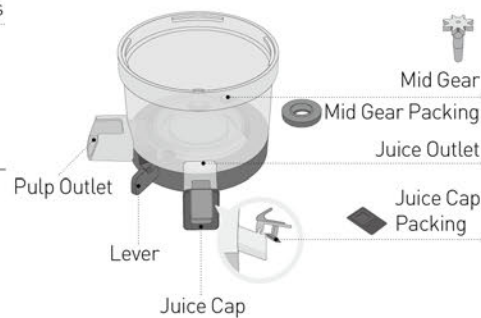

## 05 Pusher



## 06~08 Strainer

## 06 Fine Strainer



## 07 Coarse Strainer



## 08 Ice cream Strainer



## 09 Juice Container Cover



## 10 Juice Container



## 11 Pulp Container



07

## Parts and Accessories

## 12 Base

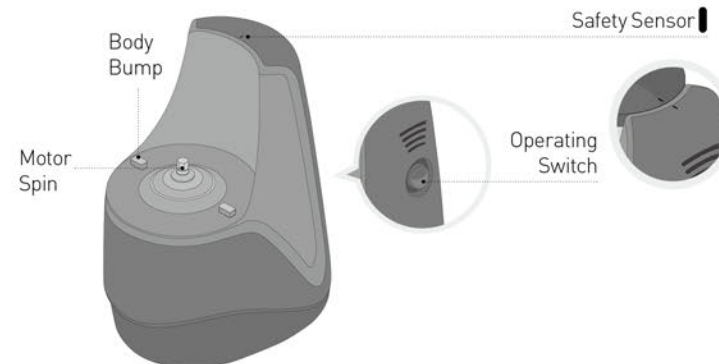

## 13 Cleaning Brush



## 14 Small Cleaning Brush



## 15 Tofu Mould

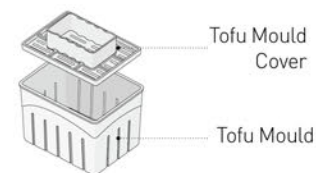

## 16 Chamber Rack

\*Chamber Rack can't be separated after assembling.

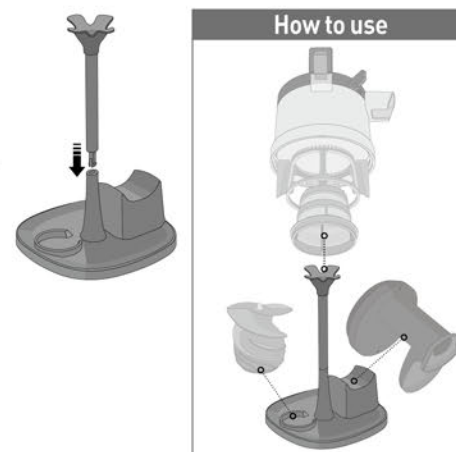

## 17 Squeezer Set





## How to disassemble the chamber

Please clean all the parts before first use.

- 1 Turn the hopper counterclockwise and pull it up.



- 2 Disassemble by lifting the strainer and spinning brush from the chamber.

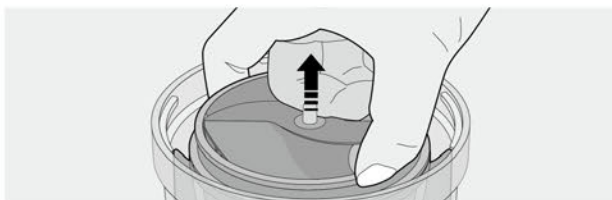

- 3 Pull out the squeezing screw holding both sides of wing.

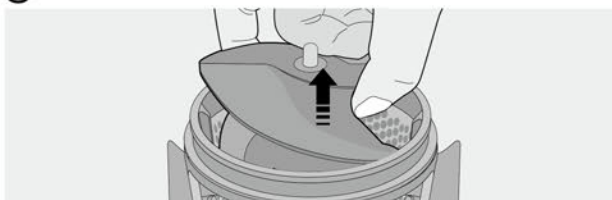

- 4 Disassemble the spinning brush and strainer.

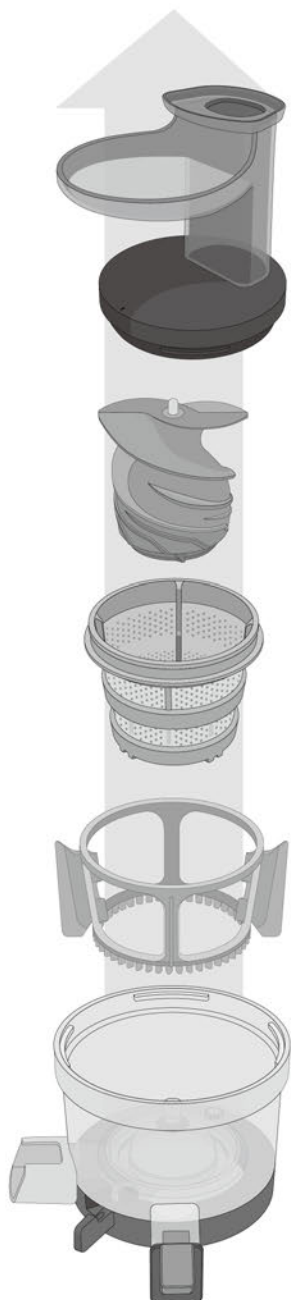
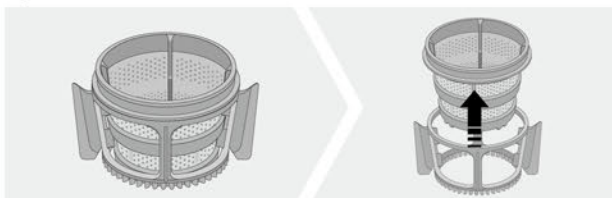

## How to trim the ingredients / Use by strainer types

### How to trim the ingredients For juicing



Apple · pear · kiwi · oriental melon	Juice fruits like pear, kiwi, oriental melon, etc. put them with seeds and peels. However, apple seeds contain toxicity, so it better to remove them.
Pomegranate · grapes	Separate each grape from the cluster. Peel the pomegranate and use flesh only.
Watermelon · melon · orange · grapefruit · lemon	Peel off the skin of watermelon, melon, orange, grapefruit, lemon and cut them into right size.
Mango · cherry · peach · lemon	Fruits like mango, cherry, peach, lemon or plum, etc. have hard seeds which are hard to swallow. Those seeds might cause stoppage or parts damage, so they must be removed before using it.
Wheat · chives · Water parsleys · angelica · celery · kale	Cut fibrous ingredients into small sized less than 3~4 cm. Put a handful of wheat or chives in not to be scattered.
Ginger · Garlic	When extracting juice from ingredients with many fibers, including ginger, slice thinly and insert slowly. When extracting juice from root vegetables, including ginger (carrot, dandelion, potato, deodeok, etc.), non-food materials such as dirt on the surface may damage the parts. Please remove peels before using the product. When extracting a large amount of juice, repeat the process of "disassembling and cleaning after extracting juice from 1kg of ingredients".

### How to trim the ingredients For making Ice cream

Flesh	Dice frozen fruits as 2cm to make ice cream. When use the testaceous fruits, please peel and freeze to use. Fruits with hard seeds such as persimmon, Japanese apricot, lemon, plum, peach etc. that are hard to chew with our teeth should be taken out before freeze. Please use seedless grapes.
-------	---

- ▶ This is a reference about how to trim the ingredients, so if you have allergy please choose your own proper ingredients which agrees with you.
- ▶ Please refer to the recipe book for the product usage of each ingredient.

### Use by strainer types

Fine Strainer	 Fine strainer has tiny and fine holes good to make clean juice.
Coarse Strainer	 Coarse strainer has larger holes so is good to make thick juice with flesh in it. It is to make juice with soft fruits and thick juice like banana, strawberry, and also useful for smoothie, latte, or soup.
Ice cream strainer	 It is for making Smoothie, slush and ice cream with frozen fruits. Do not extract large amount of ingredients at once or put the large chunk of the ingredients. The juice can be out to pulp outlet or outside of the strainer when use a little bit defrost fruits. It is natural phenomenon and not a product failure. Do not use water freezes, ice cube.

#### Note

This ice cream strainer is only for frozen fruits. Do not use for crushing ice and grinding.

# 10

## How to assemble : For juicing

1  
STEP

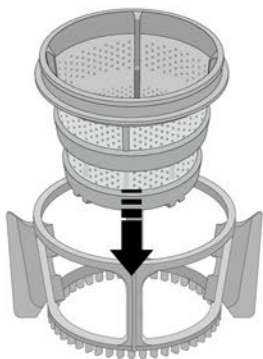

Assemble the strainer and spinning brush as shown in the picture.

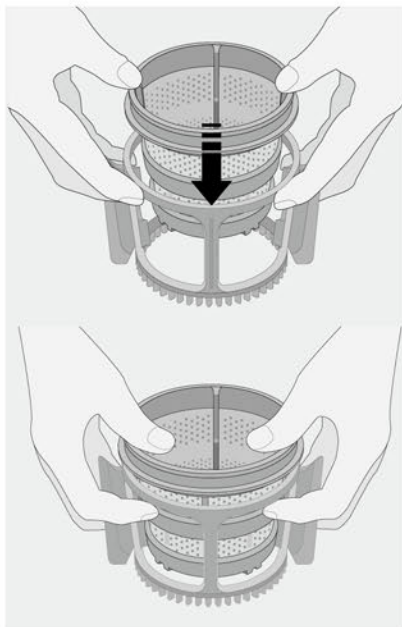

2  
STEP

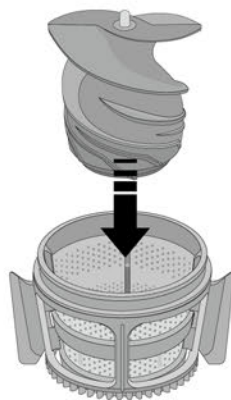

Assemble the squeezing screw into [STEP1].

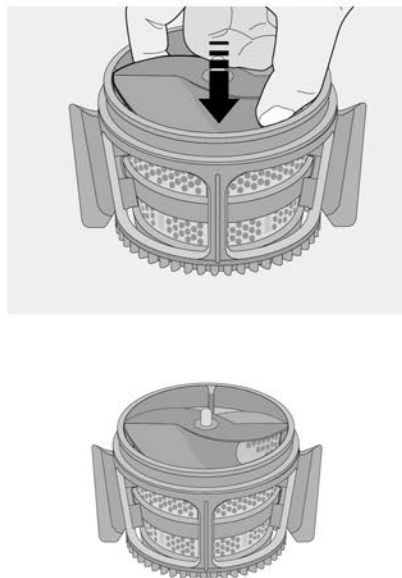

# 11

## How to assemble : For juicing

3  
STEP

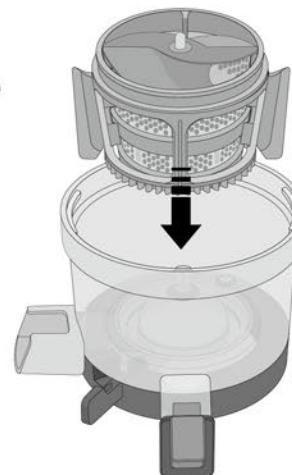

Place the assembled parts from [STEP 2] into the chamber by turning the strainer from side to side to fit the groove in the bottom bump of the chamber.

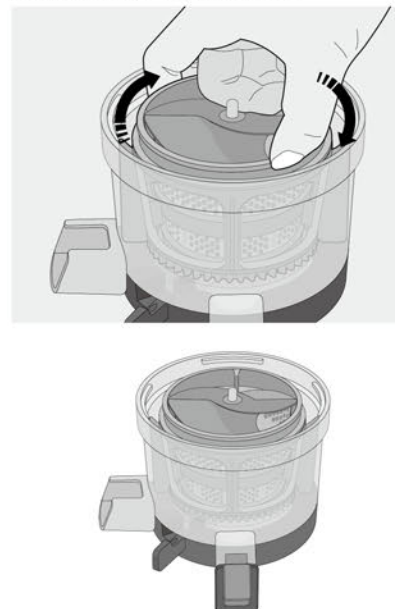

4  
STEP

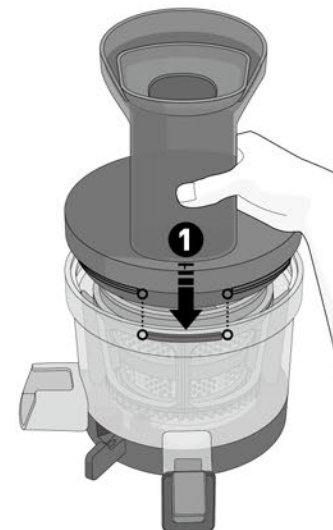

After putting the hopper on the chamber, turn it clockwise until it is locked completely.

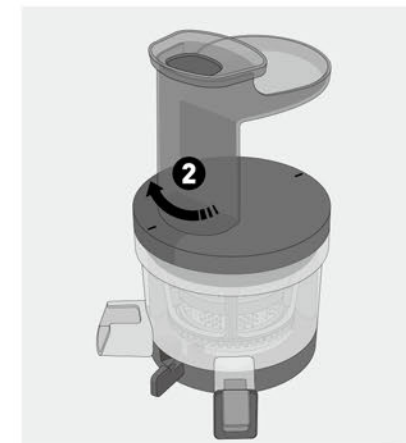

### Note

The hopper can be operated when assembled in either direction.

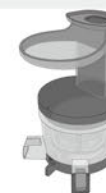

# 12

## How to assemble : For making Ice cream

1  
STEP

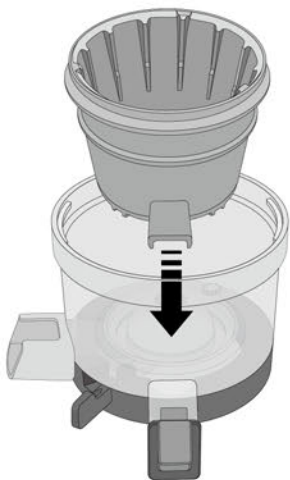

Assemble the chamber and ice cream strainer. Place the ice cream outlet align with juice outlet.

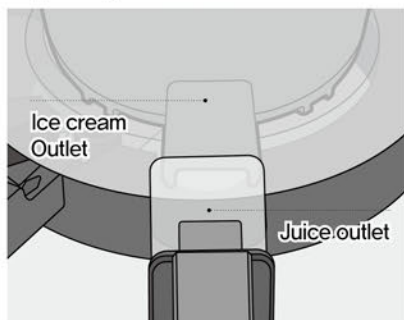

2  
STEP

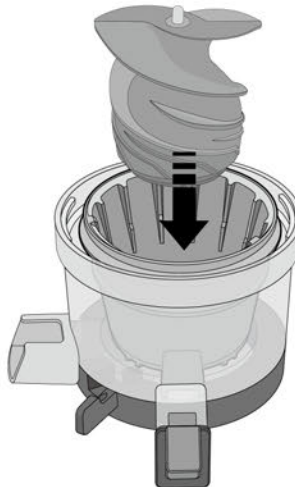

Press the squeezing screw into the assembled parts from [STEP 1] until the screw fits perfectly.

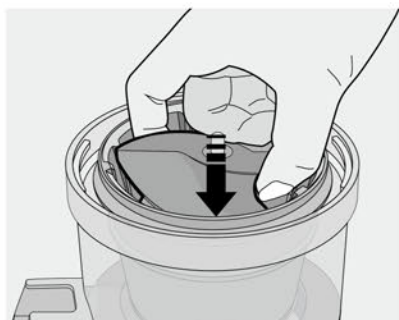

### Note



The spinning brush isn't needed for ice cream making.

# 13

## How to assemble : For making Ice cream

3  
STEP

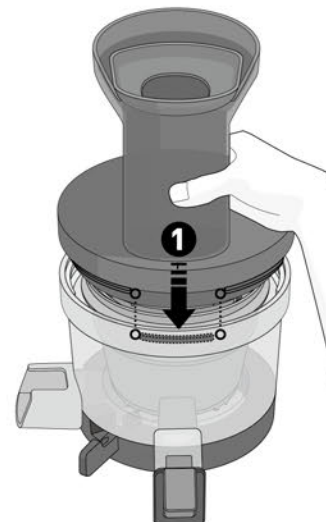

After putting the hopper on the chamber, turn it clockwise until it is locked completely.



### Note

The hopper can be operated when assembled in either direction.

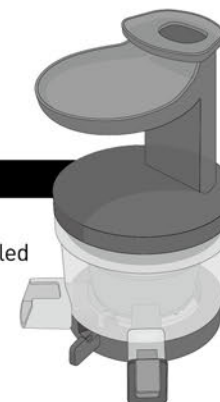



## How to assemble the chamber set and body

The assembling method is same regardless of strainer type.

- 1 Place the control lever of the chamber set to [●CLOSE] as image ①.

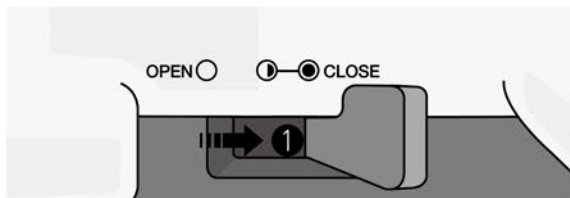

- 2 Assemble the bottom of the chamber to bump of the body. If the control lever is not placed at [●CLOSE] the chamber set and body will not fit completely.

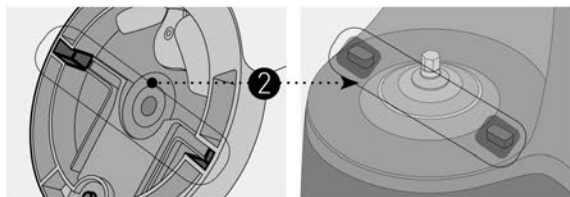

- 3 If the sign [I] on the body and the sign <I> behind of the chamber set are aligned well, it is perfectly assembled.

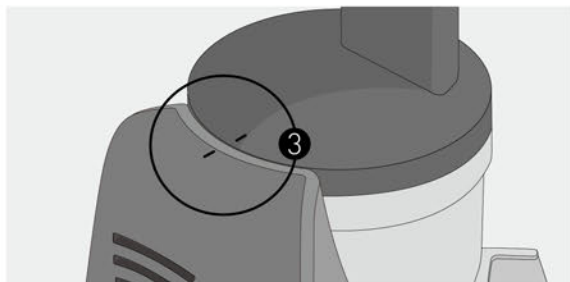

### Note

The main body itself will not work.  
The appliance will not work if the chamber set isn't assembled well even though it is on the body.



### Note

If the hopper is assembled according to the safety sensor on the main body, the appliance works even the hopper is assembled in the opposite direction as the picture below.



## How to use : For juicing / Ice cream

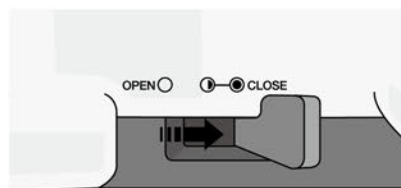

- 1 Place the lever [●CLOSE] position before operating.

The chamber will not be assembled with body if the control lever is not into CLOSE [●CLOSE] position.

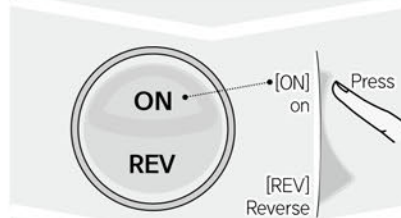

- 2 Press [ON] button to start.

For your safety, this appliance only works when it's correctly assembled with chamber set.

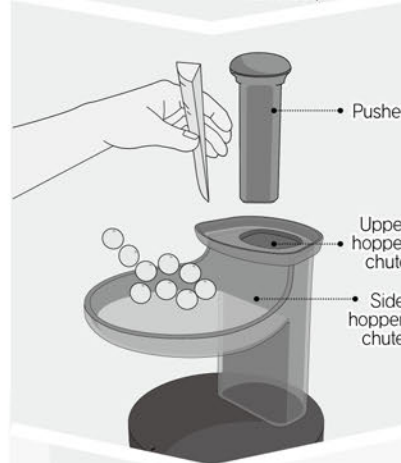

- 3 Put ingredients gradually in the hopper chute and press with the pusher.

Do not press the ingredients with anything except the pusher provided.  
Please put the ingredients as 3~4cm sizes.  
When you use the ice cream strainer, the juice can be out through outlet and it is normal operation.  
When you extract over 400ml at once, please open the control lever every 400ml to emit the pulp.

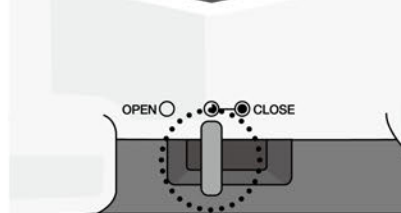

- 4 Juice : Put the lever in half-closed [●] position before putting the last ingredients.  
Ice cream : Close [●CLOSE] the control lever to use.

The hopper will be opened easily as long as the residues in the strainer are released.

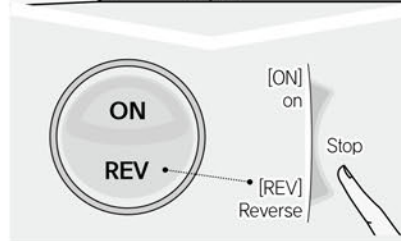

- 5 After extraction is completed, place the switch in the [REV] position.

Stop the machine slowly after press the button for safety and product performance.

### Note

When using [ON] or [REV] button, make sure that the Squeezing Screw stops completely.



## How to use control lever by mode

- \* The control lever is between the juice cap and pulp outlet.
- \* The control lever has various functions and can help to extract juice by characteristic of ingredients except extract function.

### [ ● CLOSE ] Preparation-Juice Extraction Mode

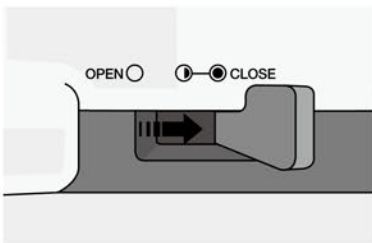

For general ingredients, the extraction rate is good when you close [●CLOSE] the lever during operation. When you extract over 400ml at once, please open the control lever every 400ml to emit the pulp.

For juicing the fruits with hard seeds, such as grapes, rubus coreanus, and pomegranates, place the control lever into close [●CLOSE] and switch into halfclosed [●] position when juice begins to come out.

### [ ● CLOSE ] Ice cream Mode

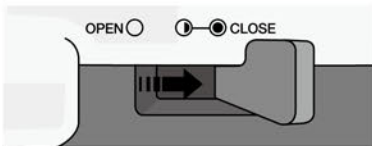

Close [●CLOSE] the control lever to use since the pulp is not released separately.

### [ ● ] Completion, Simple Cleaning Mode

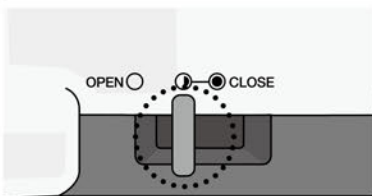

Place the control lever into half-closed [●] position when putting in the last ingredients and release the residues. The hopper will open easily when the residues in the strainer are released.

For Simple Cleaning Mode, put the lever in halfclosed [●] position and release the residues.

### [ OPEN ○ ] Cleaning Mode

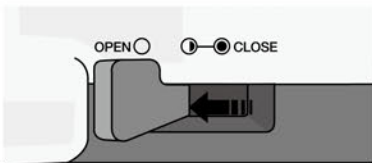

When detaching and cleaning the chamber, put the lever completely in [OPEN ○] position. You can easily and conveniently clean the chamber.

The control lever doesn't go to [OPEN ○] position when the chamber is placed on the main body.

#### Note

When it is hard to open Hopper after operation. Put the lever in half-closed [●] position and press [REV] button for 3~4 seconds. Repeat this for 2~3 time and the hopper will be opened easily.

## How to use control lever by ingredients (Juicing)

#### Note

Use the control lever by the properties of each ingredients, you can make a more delicious juice. When you extract over 400ml at once, please open the control lever every 400ml to emit the pulp. The hopper can't be opened or it may cause damage when the pressure in the chamber increases.

### Ingredients

Apple, pear, melon, watermelon, strawberry, blueberry, orange, grapefruits, lemon, mango, plum, peach, cherry, persimmon, pineapple, wheat-grass, parsley, celery, dandelion, carrot, ginger, potato, beet, tomato, paprika, broccoli, cauliflower, cabbage, kale, spinach [Cooked] sweet potato, pumpkin, corn

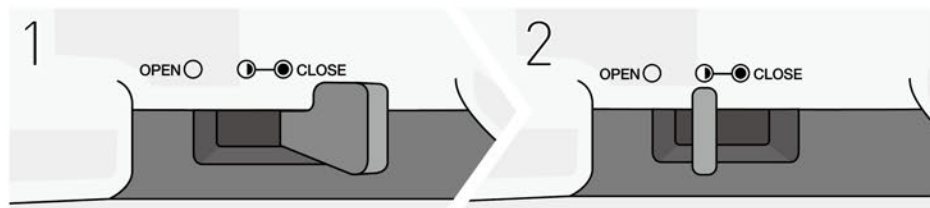

Start from control lever in [● CLOSE] position.

When extraction is almost finished, place the control lever into [●] half-opened position.

### Ingredients with seed

Grapes, pomegranate, kiwi, tomato, blackberry, raspberry, mulberry, etc.

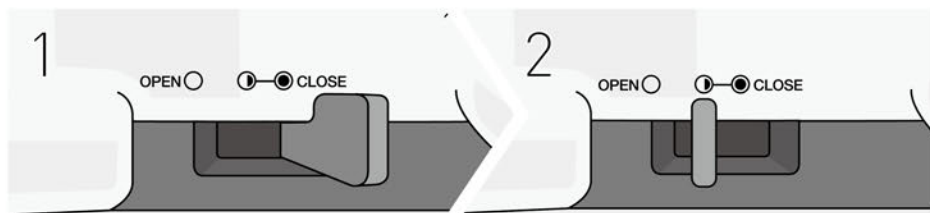

Start from control lever in [● CLOSE] position.

When juice starts to come out, place the control [●] half-opened position.

### Mix with milk

Banana, strawberry, blueberry, etc.

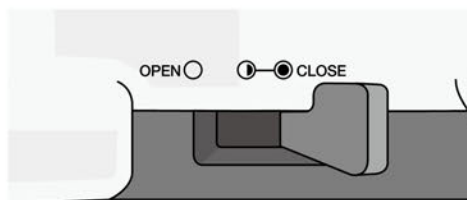

Start from control lever in [● CLOSE] position.

## Assembling and cleaning for squeezer

### How to assemble the squeezer set and body

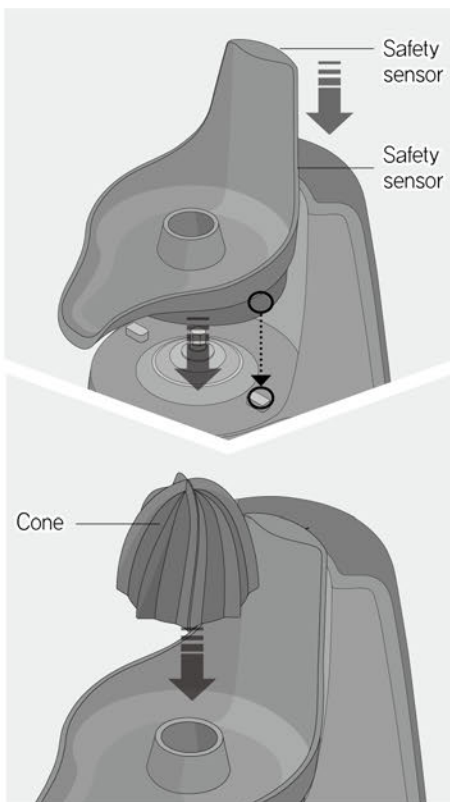

#### 1 Mount the serving spout on the body.

Align the grooves of the serving spout bottom with the bumps of the body.

#### 2 Put the cone to the spin axis on the body.

### Cleaning

1. Turn off and the remove the plug from the power outlet before cleaning.
2. Remove the cone and serving spout from the body and clean the parts under running water.
3. Rinse or wash all squeezer parts immediately after use. Dried citrus pulp is difficult to clean.

#### Note

**DO NOT WASH AT HIGH TEMPERATURES OF 80°C OR HIGHER.**  
**DO NOT PUT THE APPLIANCE AND PARTS IN A DISHWASHER, DRYER OR A MICROWAVE ETC.**  
 It may cause a failure or parts deformation.

## How to use squeezer and caution

### How to use squeezer

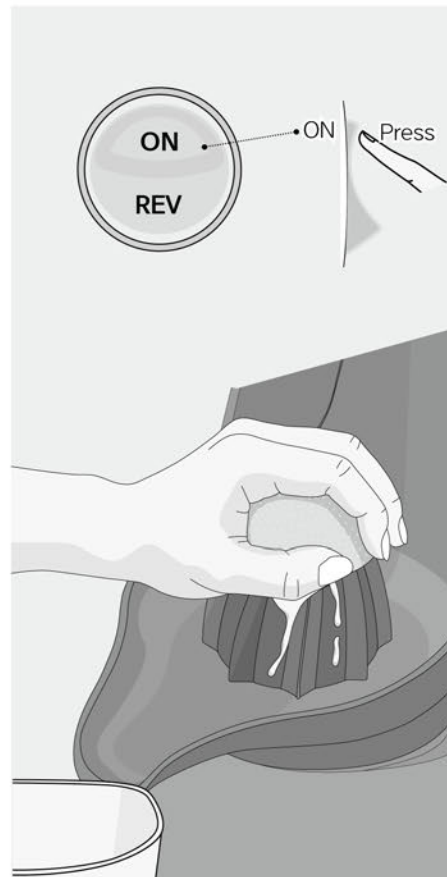

#### 1 Press the [ON] button to turn on. Prepare the juice cup that holds the juice.

#### 2 Cut the citrus fruit in half. Place a citrus fruit half onto the cone and push down gently.

If you extract an excessive amount of ingredients, it may overflow.

### How to use squeezer

Remove seeds before extract. If not removed, it may contain the seeds in juice.

If you want clear juice, use the hurom chamber for juicing

Please wash all the pesticide on the fruit before extract.

Please use fruit at room temperature than the frozen fruit in order to obtain a large amount.

Please select the fruits of smooth and bright colors and avoid fruits have solid and shrink shell.

We recommend you drink juice immediately after extraction rather than keeping them for long time.



## How to Clean

### Cleaning for parts

- 01 Unplug the power cord with dry hands after the unit has been completely stopped.
- 02 Remove the chamber set from the main body. Twist the chamber cover to open and lift up the parts in order to disassemble the unit.
- 03 Use a cleaning brush and wash the chamber set under running water.
- 04 Open the control lever [OPEN ○] and juice cap to wash the chamber.
- 05 Wipe the main body with a damp towel or a soft cloth.
- 06 The silicone packing can be disassembled and washed. (Including juice cap packing, Mid gear packing, silicone brush)
- 07 You can sterilize and clean the product by soaking it in water with diluted baking soda, citric acid or vinegar for about 30 minutes.

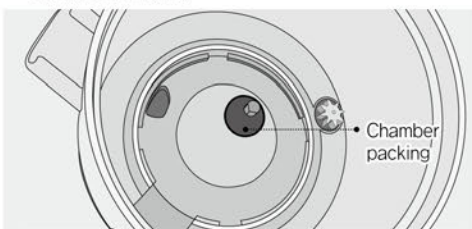

The chamber packing can't be disassembled. Do not disassemble the chamber packing. If you try to disassemble the chamber packing, it might be damaged.

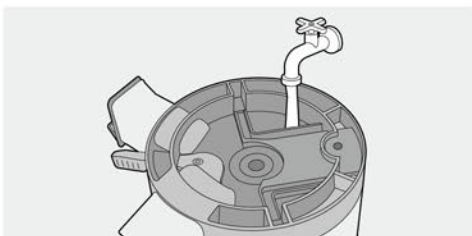

When you clean the chamber set, wash the residue inside and bottom of the chamber under running water.

#### Note

If the unit is not cleaned immediately after use, a residue may dry and stick to the unit. This will make disassembling and cleaning difficult as well as lead to performance degradation. Do not wash with hot or boiling water, an iron scrubber, abrasive material, sink solvents, or sharp cleaning tools. Do not put it in a dishwasher or dish dryer. After washing, thoroughly and naturally dry, and store in a clean area.

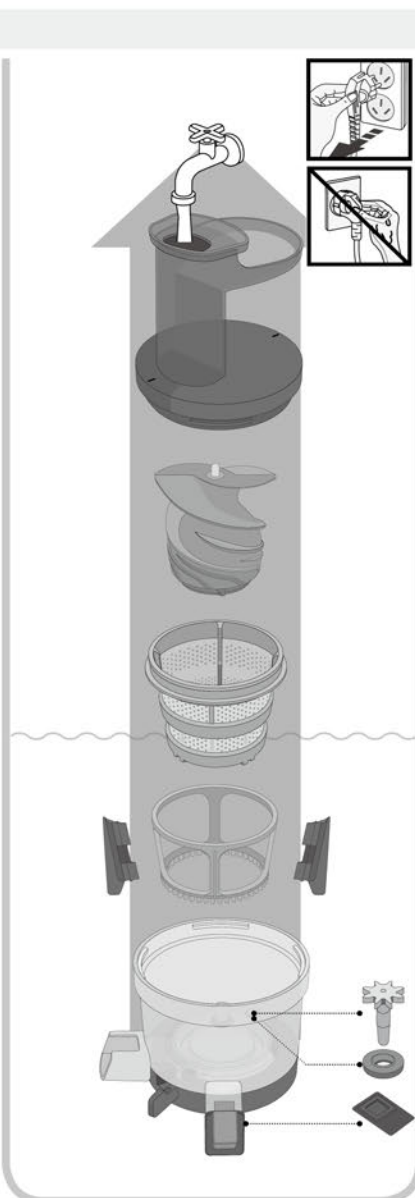

## How to Clean : Silicones

### Juice Cap Packing



Open the juice cap, hold the chamber and juice cap with one hand, and remove the juice cap packing with your other hand to disassemble.

Please be careful not to drop or damage the juice cap and chamber when disassembling the unit.

### Mid gear and Mid gear packing

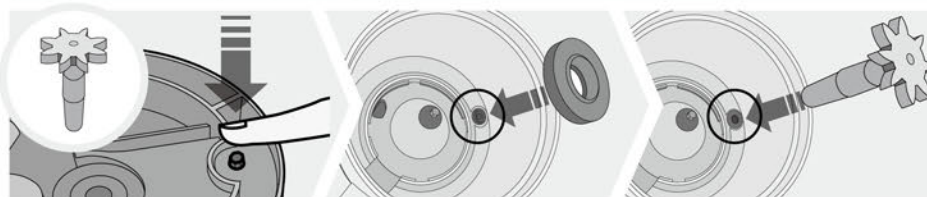

Push the mid gear from the bottom side of the chamber then the gear will be came out.

When you clean the chamber set, wash after disassemble the packing. After the cleaning, please stick the mid gear packing from the inside of the chamber.

Stick the mid gear after assembling mid gear packing.

### Silicone brush

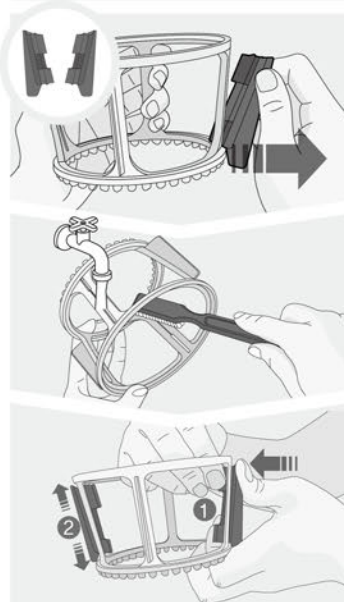

#### 1 Remove the silicone brush from the pinning brush holder.

Please follow the recommended method to separate the silicone brush. Otherwise, it may cause damage of spinning brush holder and silicone brush.

#### 2 Use a cleaning brush and wash the inside and outside of the spinning brush holder under running water.

Wash the silicone brush under running water as the same method.

#### 3 After cleaning, attach the silicone brush by pushing on the back of the brush holder, ① while pulling the inner wing inward with your other hand as shown in the picture. Pull until it cannot be pulled any further. There is a risk of damage if the product is used without being fully assembled. ② Grab the top and bottom of the outer wing and pull them tight.

If the silicone brush cannot be inserted properly, the packing may become wrinkled or fall out during juice extraction.



## Before Requesting for Repair

If you need additional information, please contact your local Customer Service Center or visit [www.hurom.com](http://www.hurom.com). When applying for after-sales service, please have the manufacturer's serial number or bar code available.

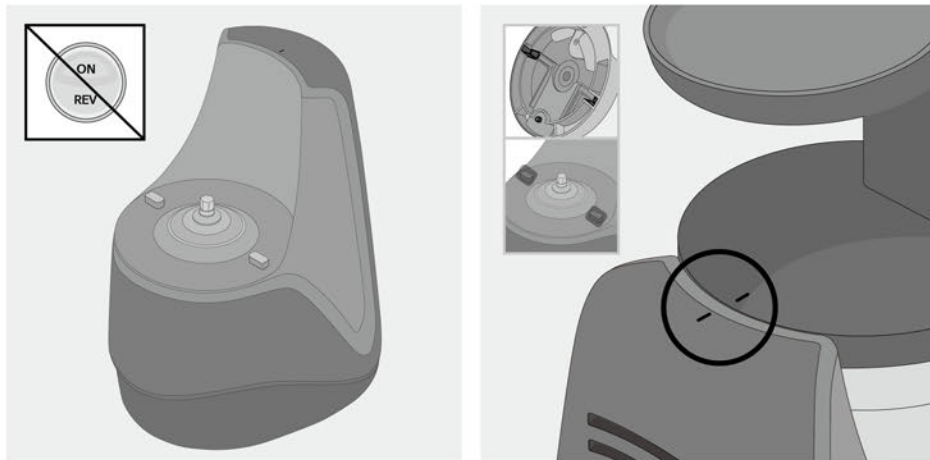

### 01 The main body itself will not work.

The main body itself will not work. For your safety, this unit only works when main body is correctly assembled with the chamber set.

### 02 Please assemble according to the safety sensor.

For your safety, this unit only works when it's correctly assembled.

### 03 The Appliance does not work.

**Make sure that the power cord is properly plugged in.**

**Check if the hopper is assembled properly.**

The appliance may not operate when used for an extended period of time (more than 30 minutes). It will work normally after the body (motor) cools down.

If the hopper has not been locked into place, the appliance will not operate for safety reasons.

**Check if the appliance is assembled according to the directions in the manual.**

Refer to instructions for assembly in the manual or consult with your Customer Service Center for additional assistance.

### 04 The appliance stops during normal operation.

**Have you in heavy loads or large pieces of ingredients into the appliance?**

Refer to page 24 of the manual and follow the guideline for using [REV] button.

If the issue is not resolved after following the above process, please contact your local Customer Service Center.

### 05 There are fine lines or scratch marks around the Squeezing Screw.

These are molding marks resulting from the normal manufacturing process.

This is a normal product and there is no problem for use.

### 06 Chamber set does not fit into the base.

If the lever is in **OPEN** ○ position, the chamber set does not fit in to the base. Before assembling

● **CLOSE** position.

## Before Requesting for Repair

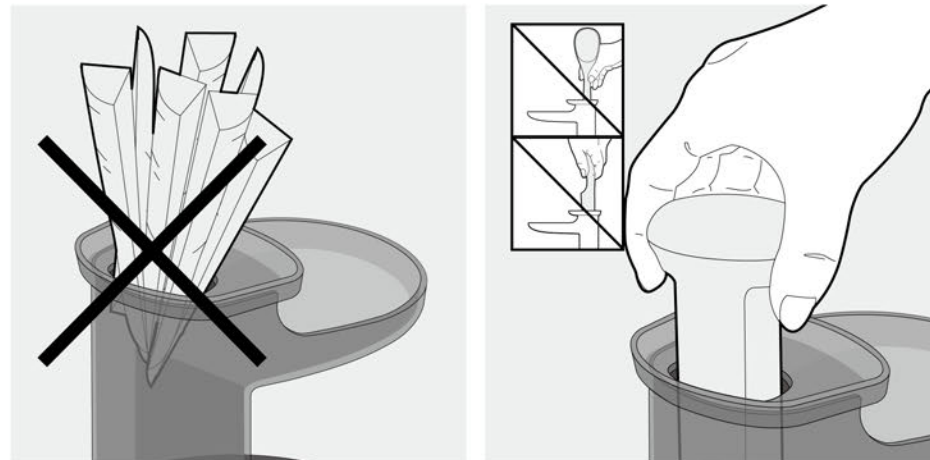

### 07 Do not insert too many ingredients at once.

If you insert an excessive amount of ingredients or thick ingredients, the unit may stop.

### 08 Do not use in ways other than pressing on the pusher in the inlet.

It may cause damage, injury, etc.

### 09 Juice leaks over the base.

**Have you inserted a lot of ingredients into the hopper chute?**

If you insert a large amount of ingredients compared to the pulp outlet, the packing is slightly pushed away, so the juice leaks out of the gap. Do not put too much ingredients by force and just put gradually for extraction. Please contact the Customer Service Center if juice continues to leak from above the body.

### 10 The hopper does not open.

There might be a lot of residues inside. Put the lever in half-closed position, and press [ON] button to release residues. Press [REV] button for 3~5 seconds and stop it. Repeat this process 2~3 times.

**Have you placed any foreign substances or solid objects (hard seed such as persimmon seed) in the juicer?**

Press [REV] button and push the ingredients back up toward the hopper chute.

Do not attempt to open by force. Please contact your local Customer Service Center for assistance.

### 11 The Chamber shakes when squeezing.

**Slight shaking may be caused by the motor.**

Depending on the texture of the ingredient, there may be slight to more pronounced shaking of This is a normal phenomenon as Squeezing Screw rotates and it is not a malfunction.

Hard ingredients (e.g carrot, potato, radish, beet, kohlrabi, etc.) may cause more shaking than soft ingredients.

## When the Squeezing Screw stops during operation

\*The appliance may stop if ingredients are overloaded or inserted quickly.

\*Gradually insert ingredients, since the product squeezes them instead of grinding.

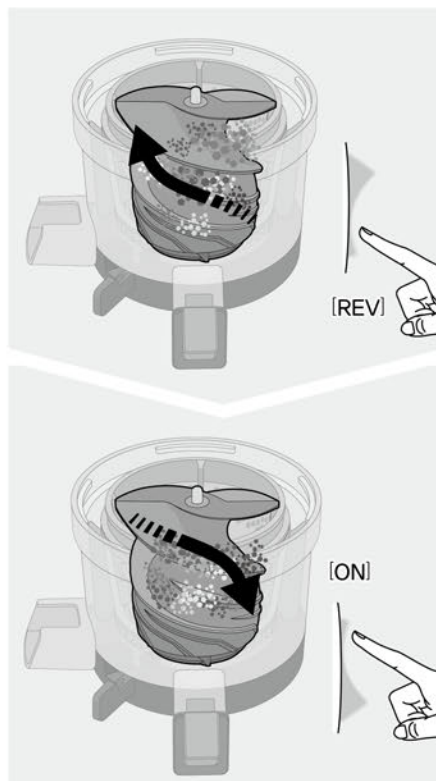

- 1 Press [REV] for 3-5 seconds to release pressure from chamber set. Repeat if necessary.

"Reverse" is a function that rotates (or operates) the screw (motor) in the opposite direction. Reverse rotation operates only while holding the switch in [REV] position, and shuts off when switch is released.

- 2 Press [ON] after reverse Squeezing Screw rotation stops completely to continue juicing.

When using [ON] or [REV] button, make sure that the squeezing screw stops completely.

### Note

Even after following the directions above and still doesn't work, please unplug the power cord and disassemble chamber set, and clean it. And try it again.

## Caution when using operation button



### Note

In case of reversing during operation, press [REV] button shortly to stop the appliance, then you press [REV] button for operation. From the feature of the product, even though you stop the operation, it doesn't stop right away. It rotates slowly then stops. If the rotation stops completely, you may press the button to any direction you want.

## Product Specifications / Warranty

### Product Specifications

Product Name	Hurom Slow Juicer	Cord Length	1.4 m
Model Name	H-AE Series	Motor	Single-phase induction motor
Rated Voltage	120 V	Fuse	250 V 8 A
Rated Frequency	60 Hz	Weight	6.6 kg (14.5lb)
Rated Power Consumption	150 W <small>Energy efficiency is low at high rated power consumption[W]</small>	Outward Dimension	Width 249mm Length 186 mm Height 429 mm
RPM	43 rpm	Squeezer Dimension	Width 136mm Length 175 mm Height 128 mm
Rated Operating Hour	Less than 30 minutes		

### Warranty

Product name	Customer name	Model name
Supplier	Date of purchase	Manufacture's serial number
Address		

1. Important: To better protect your purchase, fill out and mail this form to a local distributor where you purchased the appliance and keep the original receipt.

2. This certifies that the Hurom Slow juicer is covered under warranty by **HUROM** to be free from defects in material construction and workmanship.

Hurom provides warranty for ten (10) years for the motor and two (2) years for other parts from the date of purchase by the original purchaser. Coverage is valid only with proof of purchase from an Authorized Local Distributor. (No international warranty available)

This warranty does not apply to damages caused by accident, misuse, abuse, commercial use, alteration, failure to follow operating instructions, or damage caused by parts or service unauthorized by **HUROM**. Damages caused by transportation must be claimed with carrier. **HUROM** disclaims all responsibilities for consequential damages from incidental losses caused by use of this appliance.

3. Please check the bottom of your Hurom product for a sticker with a barcode.

This barcode sticker helps verify a genuine Hurom product and identify the product manufacturing date. Hurom's manufacturer's warranty does not cover products with missing or damaged barcode stickers. Products are to be inspected upon receipt.

4. For service and assistance with technical difficulty, please contact our local customer care center.

Manufacture : **HUROM**  
Hurom webpage : [www.hurom.com](http://www.hurom.com)

26

MEMO

27

MEMO



